

D Series Circulating Pumps

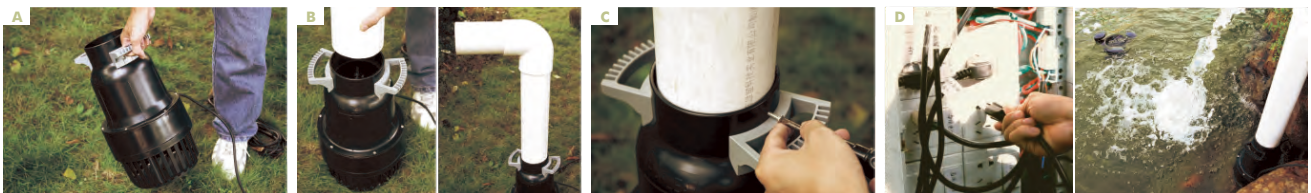

HAILEA asynchronous solids-handling waterfall and filter pumps accomplish what most other pumps only aspire to achieve. The combination of energy-efficient performance, flow and ease of maintenance make this pump the ideal choice for discriminating pond owners. The HAILEA protective pre-filter cage allows the pump to be placed directly into the pond. HAILEA pumps are able to pump solids up to one quarter of an inch making it ideal for use with external pressure filters or HAILEA waterfalls type filter systems.



- A. Open the box, take out the pump and accessories.
- B-C. Choose the right connection pipe and connect it to the pump's water outlet.
- D. Release the pump into the pond, put it at the desirable position. Fix the pump well as its high flow will move the pump easily if it is not fixed tightly. Plug in the rated main power with leakage-protection device.

Product details

- Low power consumption, large flow rate.
- Pre-filter cap for particle sizes up to 8mm.
- Adopts ceramic bearings for continuous use.
- Built-in thermal overload trip for safe protection.
- High performance design. High efficiency & energy saving.
- All the electrical parts are embedded in a block of plastic resin.

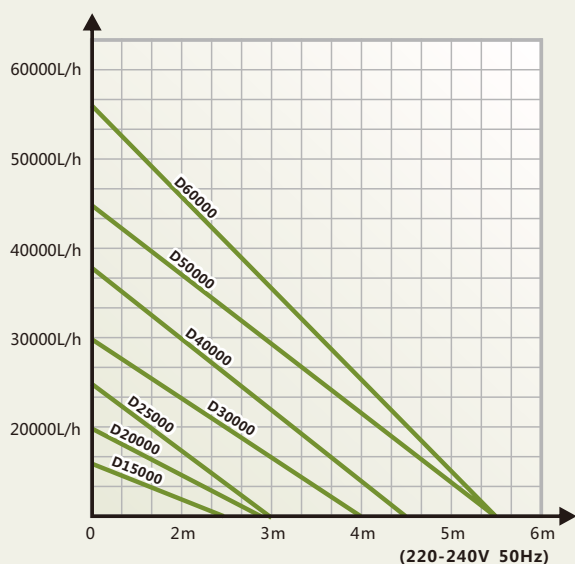

Large water outlet for high flow rate.



Handles for easy movement of the pumps outside of inside water.



Water inlet with ribs for stopping large particles moving into the pump and increasing the water inlet volume.

Specifications

| Model | Voltage/Frequency | | | Hose Diameter |
|--------|-------------------|----------|------|---------------|
| | 220-240V/50Hz | | | |
| | Power | Qmax | Hmax | |
| D15000 | 128W | 16100L/h | 2.5m | Ø 110mm |
| D20000 | 158W | 20000L/h | 2.8m | |
| D25000 | 188W | 25000L/h | 3.0m | |
| D30000 | 235W | 30000L/h | 4.0m | |
| D40000 | 299W | 38000L/h | 4.5m | |
| D50000 | 398W | 45000L/h | 5.5m | |
| D60000 | 560W | 56000L/h | 5.5m | |

Suggested pond installation

